

Swab DNA Storage Tube

口腔拭子DNA保存管

产品简介/Description

本产品采用医疗专用的尼龙植绒为原材料，创新的喷射式植入尼龙植绒，以最大限度的提高采样拭子采样效率，尼龙纤维垂直且均匀附着在拭子头表面，极大增加细胞和液体样本的收集和释放效率。采样拭子头可折断，使用方便。口腔拭子保存液能够常温保存口腔拭子DNA长达1个月，其获得的DNA可用来完成各种基因检测及分析实验，如qPCR、NGS、SNP分析。为运输和存储提供方便，并减低其成本。

Using medical-special nylon flocking as raw material, innovative spray-type nylon flocking to maximize the sampling swab sampling efficiency, nylon fiber vertically and evenly attached to the surface of the swab head, greatly increasing cells and the efficiency of collection and release of liquid samples. The sampling swab head can be break and easy to use. The oral swab DNA can be store for 1 month at room temperature, and the DNA sample can be used for various gene detection and analysis experiments, such as qPCR, NGS, and SNP analysis. Convenient for transportation and storage, and reduce its cost.

产品优势/ Advantage

- ❖ 辐射消毒，确保产品无菌。
Ray of Co (60) for sterilization, ensure product sterility.
- ❖ 采用国际通用的方便灭菌的纸塑包装。
It adopts internationally accepted paper-plastic packaging for sterilization.
- ❖ 可个性化的独立密封包装，使用方便，操作简单。
Personalized and sealed Packaging, easy to use and operate.

保存条件/ Storage

- ❖ 产品应在室温（4~35℃）下保存；

Lakebio Swab DNA Storage Tube should be stored at room temperature (4~35℃)

- ❖ 使用该产品采集样品后，可在-20~35℃下保存及运输。

After collecting the sample, it can be stored and transported at -20~35℃.

产品包装/Content

名称 / Content	规格/Specification
细胞保存液 Cell DNA Preservative	1支/bottle
口腔采样拭子 Oral swab	1支/each

使用方法/ Using steps

- 1) 取样前清洁双手，用清水漱口1-2次，以便去除口腔中的食物残渣，如口腔中仍剩余的清水，应吐净。

Wash hands before sampling; rinse your mouth with water 1-2 times, in order to remove food residue, if there is still water in the mouth, it should be spit.

- 2) 撕开采样口腔拭子外包装, 取出拭子。请勿接触拭子棉头。

Peel open the packaging of Oral swab and remove the swab. Do not touch the swab tip.

- 3) 将棉签伸进口腔内，在内侧颊粘膜处反复擦拭10次以上，至棉头已经被唾液充分浸润，肉眼观察棉头应无食物残渣等异物粘附。

Put the oral swab into the oral cavity, and clean the buccal mucosa with oral swab more than 10 times until the cotton head has been fully infiltrated by the saliva, make sure free from foreign matter, such as food residue.

- 4) 旋开保存液管盖，将采样后的拭子棉签放入样本采集管内，沿手柄上的红色折痕折断手柄。

Remove the tube cap, insert the swab into the tube, and then break the handle at the red score point.

- 5) 随即旋紧保存液管盖，完成样品取样。

Immediately tighten the tube cap and complete sample sampling.

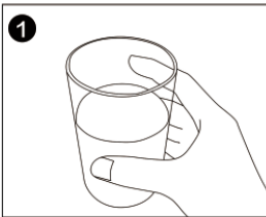

1 清水漱口1-2次
Rinse your mouth with water 1-2 times

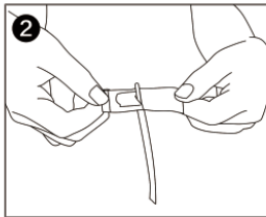

2 取出拭子
Peel open the packaging of Oral swab

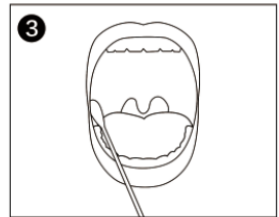

3 内侧面颊粘膜处反复擦拭10次以上
Clean the buccal mucosa with oral swab more than 10 times

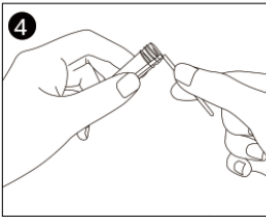

4 沿红色折痕折断
Break the handle at the red score point

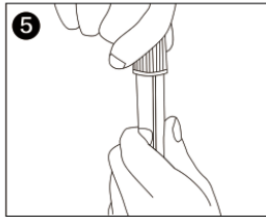

5 拧紧盖帽
Tighten the tube cap

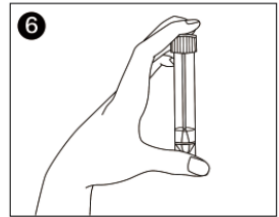

6 完成
The end

注意事项/Attention

- ❖ 产品使用前检查产品是否在有效期内、包装是否破损、保存液是否发生泄漏，如过期、包装破损、保存液泄漏等异常情况，请勿使用。
Check whether the product is in the valid period, the package is damaged, the preservation solution leaks, if not, please don't use.
- ❖ 采样拭子除了口腔外请不要接触到其他物体，如碰触到其他物体或采样过程中棉头脱落，请更换新的口腔拭子进行采样。
The swab head do not touch anything except the oral cavity. If have, please replace it with a new one.

- ❖ 采集的口腔拭子样本可稳定保存1个月，鉴于样本存在的个体差异，不同样本的具体保存期限有所波动。

The collected oral swab samples can be stored stably for 1 month, and the specific shelf life of different samples fluctuates due to the individual differences in the samples.

- ❖ 本产品为一次性使用拭子，请勿重复使用。
For single use only.